

KCU-02

Monitoring Module / RS485 Module



固也泰電子工業有限公司
KUTAI ELECTRONICS INDUSTRY CO., LTD.



Headquarters : No.3, Ln. 201, Qianfu St., Qianzhen Dist., Kaohsiung City 80664, Taiwan

Tel : + 886-7-8121771

Fax : + 886-7-8121775

URL : <http://www.kutai.com.tw>

SECTION 1 : INTRODUCTION

The KCU-02 is the RS485 module that is designed to enable the Kutai Electronics genset controllers (AMF-10, GCU-100, GCU-3000) to be operated and monitored remotely.

Via the designated operation software (Please reference from KCU-02 software user manual) user can program and change parameters remotely instead of accessing program through the controller in person.

To access KCU-02 from the PC, user must be equipped with a RS232 – RS485 adapter or USB – RS485 adapter.

MAIN CHARACTERISTICS :

- The KCU-02 software interface is user friendly which makes it easy for user to monitor and change program setting remotely.
- The RS485 programmable range from local connection (Slave Address) is 1 ~ 99.
- During communication with the controller, the KCU-02 automatically programs the RS485 protocol slave address and transmitting rate according to the controller's system parameter setting.

SECTION 2 : DIMENSION

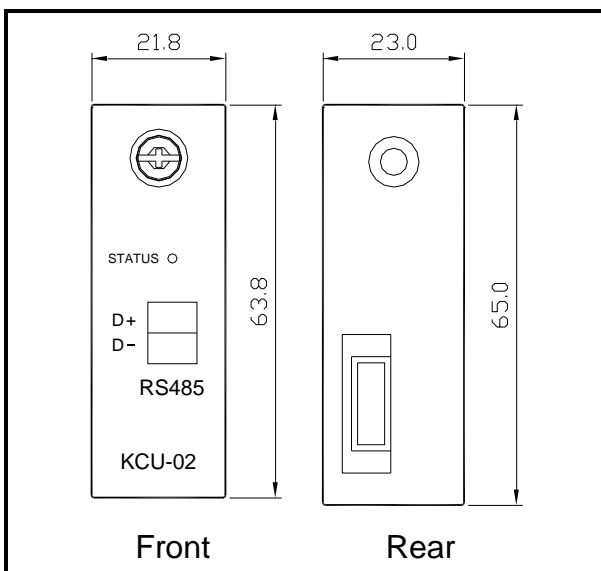

SECTION 3 : INSTALLATION

Disconnect controller power source and follow the below illustrations to complete the installation of KCU-02.

Step 1 : Remove slot cover from the back of controller.

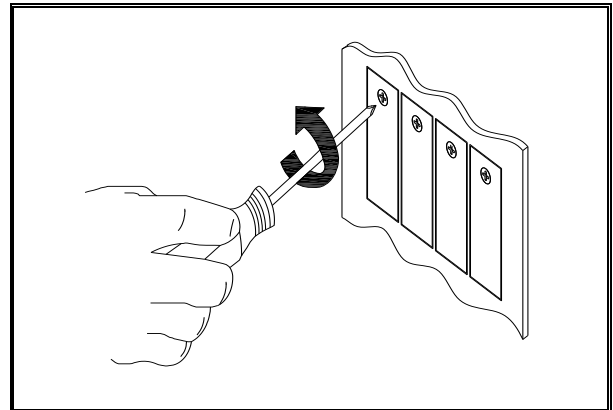

Step 2 : Insert KCU-02 into the designated slot.

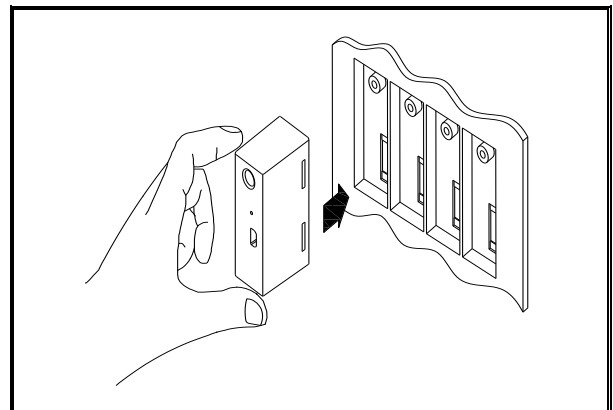

Step 3 : Tighten the screw.

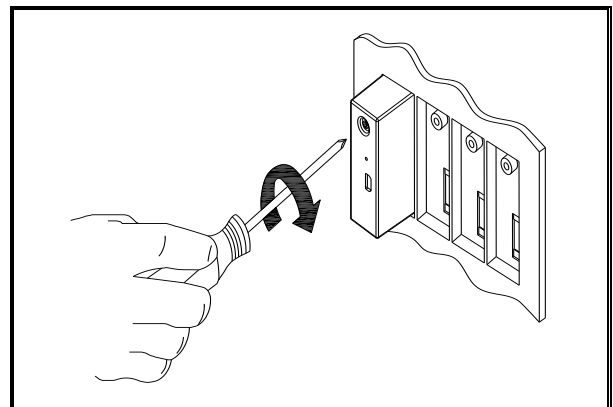

Step 4 : Start up the controller and operate through the controller front panel and enter system setting to program corresponding startup settings (Remote operation activation).

The KCU-02 currently supports AMF-10, GCU-100, GCU-3000, ATS-22, ATS-33, ATS-34 and ATS-PLC etc. controllers. The followings are the basic description of operation settings. For more detail information, please reference from the controller's operation manual.

AMF-10 & GCU-100	
ITEM	DESCRIPTION
54	Allows remote operation
55	KCU-02 module address setting
54	KCU-02 module and PC baud rate setting

GCU-3000	
ITEM	DESCRIPTION
69	Allows remote operation
70	KCU-02 module address setting
71	KCU-02 module and PC baud rate setting

ATS-22	
ITEM	DESCRIPTION
33	Allows remote operation
34	KCU-02 module address setting
35	KCU-02 module and PC baud rate setting

ATS-33	
ITEM	DESCRIPTION
24	Allows remote operation
25	KCU-02 module address setting
26	KCU-02 module and PC baud rate setting

ATS-34	
ITEM	DESCRIPTION
22	Allows remote operation
23	KCU-02 module address setting
24	KCU-02 module and PC baud rate setting

ATS-PLC	
ITEM	DESCRIPTION
Communication Setting	ON / OFF ATS-PLC Communication Interface
	RS485 Slave Address Setting
	RS485 baud rate Setting

Remark : If remote access is programmed to "Remote access cancelled" or "turn OFFATS-PLC communication interface", user can only execute monitoring and changing system parameter and unable to execute controller command.

SECTION 4 : OPERATION

For more information on KCU-02 Data link status LED indicator, please reference from chapter 5.

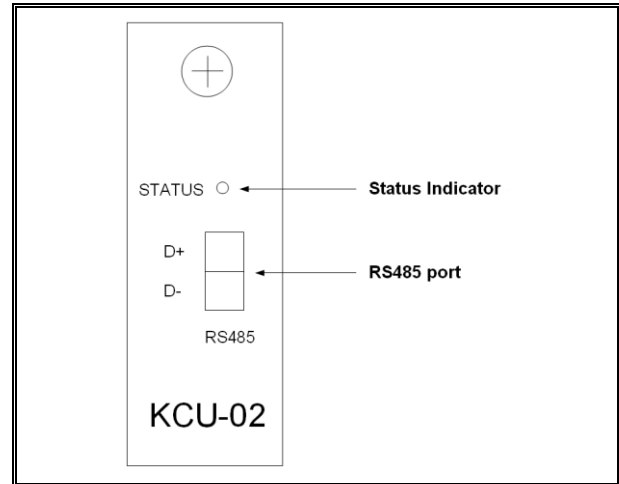

It is strongly suggested to use insulated dual-core braided harness for RS485 wiring connection with insulated grounding harness on one side.

When more than one controller are connected in a closed area network, the slave address setting on each controller can not be identical (0 = Cancelled, 1 ~ 99) but the transmission rate needs to be the same (Factory original setting recommended Program setting table item 03 : 38400).

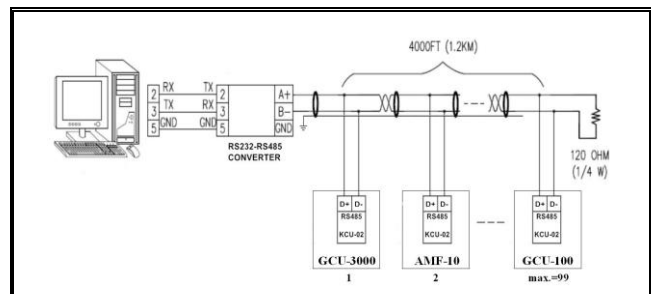

From the system connection example, the connection between the PC RS485 device to the KCU-02 should be A+ to D+ and B- to D-. A 120Ω (1/4W) terminal resistor is to be connected to the KCU-02 terminal on the farthest Controller in the connection.

System connection example :



SECTION 5 : STATUS INDICATOR & TROUBLESHOOTINGS

5.1 Through the KCU-02 LED status indicator user can understand the current operating status

STATUS	DESCRIPTION
 Flash	KCU-02 communicating with Controller
 On	KCU-02 communicating with PC
 Flash	KCU-02 abnormal status

5.2 Trouble shootings

STATUS	CAUSE OF FAILURE	TROUBLESHOOTING
 Flash	KCU-02 Memory crashed	Replace KCU-01 or contact the nearest dealer
LED Indicator No transition	KCU-02 Do not operate	<ol style="list-style-type: none"> 1. Controller is under AUTO mode: Check the status of controller and if the controller is providing a failure signal, please proceed to eliminate the cause of failure and reconnect KCU-02. If the problem persists please change KCU-02 or contact the nearest dealer. 2. Controller is not under AUTO mode: Check the status of controller and if the controller is providing a failure signal, please proceed to eliminate the cause of failure and reconnect KCU-02. If the controller is operating normally, then please switch the controller to OFF mode and disconnect power for a few seconds then reconnect. If the problem still persists please change KCU-02 or contact the nearest dealer. 3. If the Controller is crashed: Firstly, disconnect power then remove all external module(s). Reconnect controller power and after eliminate the failure disconnect controller power again and connect KCU-02 to the controller and connect to power. If the problem still persists please change KCU-02 or contact the nearest dealer.